



00212515202200016930050051

I, Dana W. Jenkins, County Clerk, do hereby certify that the within instrument was recorded in the Lincoln County Book of Records on the above date and time. WITNESS my hand and seal of said office affixed.

Dana W. Jenkins, Lincoln County Clerk



After recording, please return to:  
City of Waldport  
PO Box 1120  
Waldport, OR 97394

ORDINANCE NO. 778

AN ORDINANCE PURSUANT TO ORS 222.125, DECLARING THE ANNEXATION OF LAND CONTIGUOUS TO THE PRESENT CITY LIMITS OF THE CITY OF WALDPOR, SAID LAND IDENTIFIED ON LINCOLN COUNTY ASSESSOR'S MAP 13-11-19-00 AS TAX LOT #00202 AND 13-11-30-AB AS TAX LOT #00800.

The City Council of the City of Waldport finds as follows:

1. Pursuant to ORS 222.125, the property owner is the City of Waldport, and consents to the annexation of said real property into the City of Waldport. The City has determined that there are no electors residing on the property. The City Council has elected to dispense with an election on the annexation within the City and within the subject real property and to not hold a hearing on the annexation as allowed under ORS 222.125.
2. The subject real property is contiguous to the present boundary of the City of Waldport and is a logical extension of the boundary.
3. Annexation of the subject property is consistent with the applicable policies of the Waldport Comprehensive Plan ("Plan"). The subject Property Zoning will remain Public Facility.
4. Annexation of the real property described in Exhibits "A" and "B" will enhance opportunities for compact urban growth, the development of efficient land use patterns, and an orderly, economic provision of public services and infrastructure to the subject real property. The property owner requesting annexation has been informed that extensions of, and connections to public infrastructure will be made at the property owner's expense.

NOW, THEREFORE, the City of Waldport ordains as follows:

- Section 1. The foregoing findings are approved and incorporated herein.
- Section 2. The subject real property shown on Exhibit "A" and detailed on Exhibit "B" is hereby annexed to the City of Waldport as a part thereof.
- Section 3. This annexation is made pursuant to ORS 222.125. The owner of the subject real property hereby consents to the annexation.

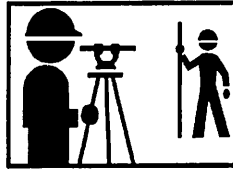
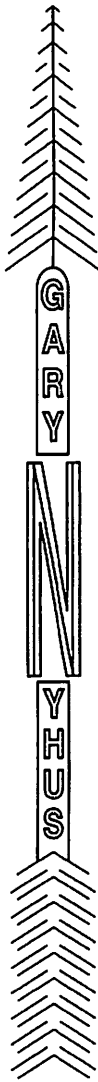

# Nyhus Surveying, Inc.

Gary K. Nyhus, PLS

P.O. Box 206 / 740 E. Thissell Rd. • Tidewater, OR 97390 • 541-528-3234 • (Fax) 541-528-3234  
nyhussurveying@peak.org

## LEGAL DESCRIPTION PREPARED FOR THE CITY OF WALDPOR

### LINCOLN COUNTY ASSESSOR'S ID 13-11-19-00 TAX LOT 202

A TRACT OF LAND LOCATED IN THE SOUTHEAST CORNER OF SECTION 19, TOWNSHIP 13 SOUTH, RANGE 11 WEST, OF THE WILLAMETTE MERIDIAN, IN LINCOLN COUNTY, OREGON, DESCRIBED AS FOLLOWS:

PARCEL 2, LINCOLN COUNTY PARTITION PLAT 1993-50

REGISTERED  
PROFESSIONAL  
LAND SURVEYOR

  
OREGON  
SEPTEMBER 13, 2016  
STEVEN E. NYHUS  
86420PLS

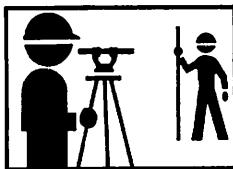
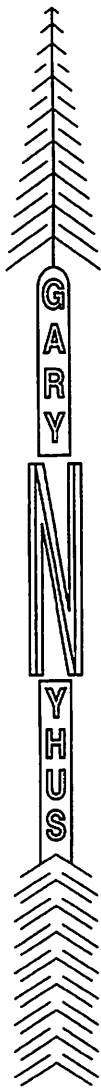

# Nyhus Surveying, Inc.

Gary K. Nyhus, PLS

P.O. Box 206 / 740 E. Thissell Rd. • Tidewater, OR 97390 • 541-528-3234 • (Fax) 541-528-3234

nyhussurveying@peak.org

## LEGAL DESCRIPTION PREPARED FOR THE CITY OF WALDPOR

### LINCOLN COUNTY ASSESSOR'S ID 13-11-19-00 TAX LOT 202

A TRACT OF LAND LOCATED IN THE SOUTHEAST QUARTER OF SECTION 19, TOWNSHIP 13 SOUTH, RANGE 11 WEST, OF THE WILLAMETTE MERIDIAN, IN LINCOLN COUNTY, OREGON, DESCRIBED AS FOLLOWS:

PARCEL 2, LINCOLN COUNTY PARTITION PLAT 1993-50

*THE EXTERIOR METES AND BOUNDS OF SAID PARCEL DESCRIBED AS FOLLOWS:*

BEGINNING AT THE ¼ CORNER TO SECTIONS 19 AND 20, TOWNSHIP 13 SOUTH, RANGE 11 WEST, WILLAMETTE MERIDIAN, IN LINCOLN COUNTY, OREGON; THENCE NORTH 87° 55' 13" WEST, 672.53 FEET; THENCE SOUTH 24° 43' 47" WEST, 94.94 FEET; THENCE SOUTH 02° 41' 47" WEST, 323.43 FEET; THENCE SOUTH 24° 07' 13" EAST, 35.00 FEET TO THE TRUE POINT OF BEGINNING; THENCE SOUTH 24° 07' 13" EAST, 238.85 FEET; THENCE SOUTH 00° 06' 13" EAST, 258.07 FEET; THENCE SOUTH 08° 09' 43" EAST, 243.13 FEET; THENCE SOUTH 02° 50' 43" EAST, 141.20 FEET; THENCE SOUTH 16° 07' 17" WEST, 27.98 FEET; THENCE NORTH 87° 50' 19" WEST, 807.66 FEET; THENCE NORTH 02° 46' 36" EAST, 772.63 FEET; THENCE SOUTH 87° 55' 13" EAST, 428.83 FEET; THENCE NORTH 64° 54' 07" EAST, 231.09 FEET TO THE TRUE POINT OF BEGINNING.

REGISTERED  
PROFESSIONAL  
LAND SURVEYOR

OREGON  
SEPTEMBER 13, 2016  
STEVEN E. NYHUS  
86420PLS

THIS MAP WAS PREPARED FOR  
ASSESSMENT PURPOSE ONLY

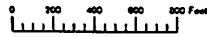

SECTION 19 T.13S. R.11W. W.M.  
LINCOLN COUNTY  
1" = 400'

13 11 19  
WALDPORT

Canceled  
201-21  
400  
500  
600  
601  
602  
609  
600  
801  
802  
809  
900  
1000  
1100  
1200  
1300  
1400  
1500  
1501  
1502  
1503  
1504  
1600  
1800  
2000  
2100  
2200  
2200-31  
2201

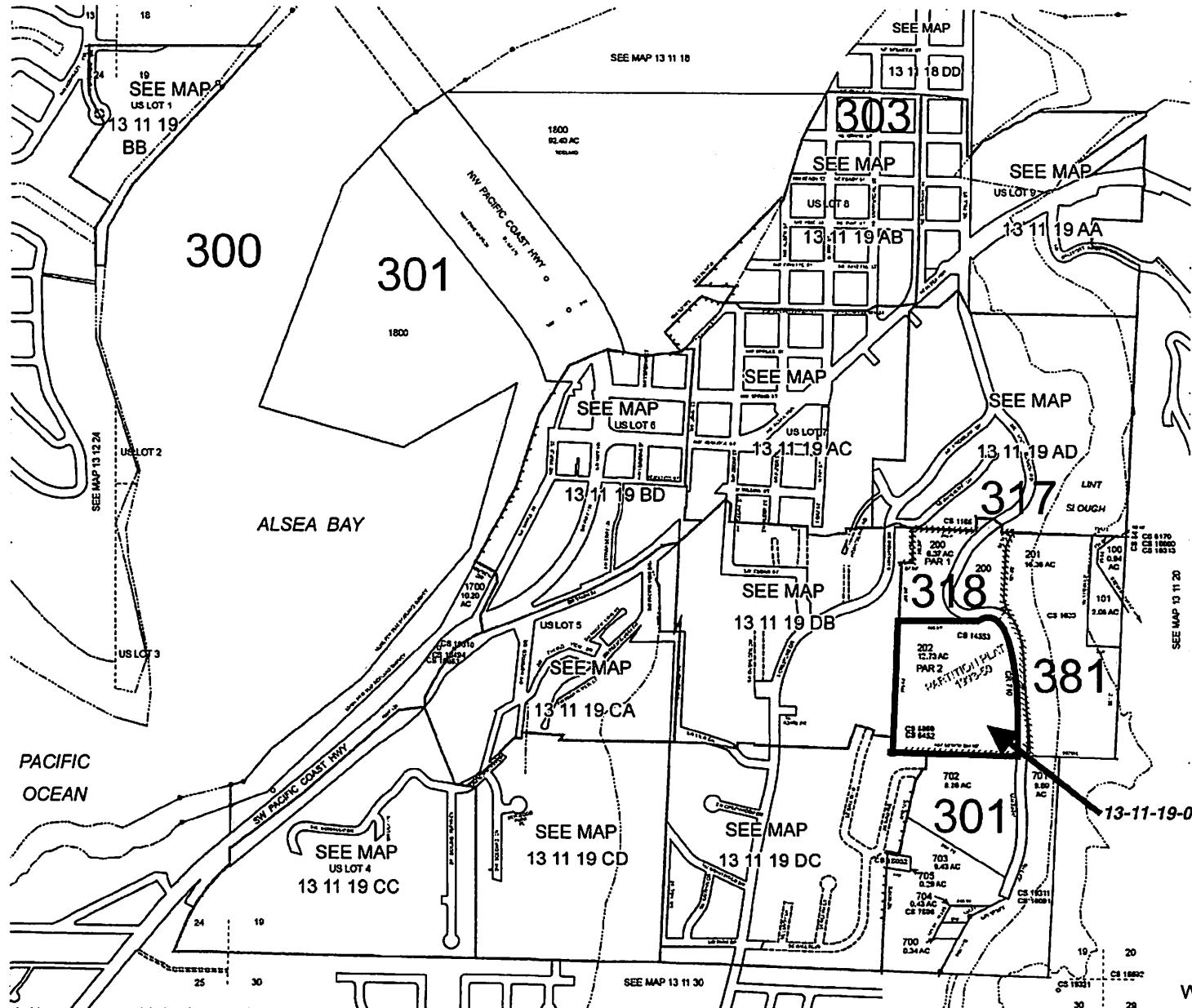

Exhibit "A" 142

13-11-19-00-00202

Revised: SEB  
07/27/2010

WALDPORT  
13 11 19

