

A B C

Instructions to Voter:
use pencil only
 To ensure your vote counts, completely fill in the oval ● to the left of the response of your choice.

Attention!
 Remember to inspect your ballot for mistakes! If you make a mistake or damage your ballot, call your County Elections Office to ask for a replacement ballot at: 541-265-4131.

City of Yachats

21-105 Proposed Withdrawal of Territory and Annexation of Hamilton Property

Question: Shall eastern 1.80 acres of certain Hamilton property be withdrawn from city boundary, and western 1.80 acres annexed to city?

Summary: The Yachats Charter provides that the existing city boundary may be modified by the voters. Both withdrawal of territory, i.e. de-annexation, and annexation would be a modification of city boundaries. Approval of this property owner requested measure would reconfigure the Yachats city limits on generally the northern boundary while not increasing or decreasing the net amount of land within the city limits. Currently, 1.80 acres of the 5.37 acre Hamilton lot is within the city limits and located on the northern end of city on the east side of Hwy. 101. The 1.80 acres within the city is shaped like a wedge. The reconfigured city limits would bring a 1.80 acre portion of the property fronting Highway 101 into the city, and withdraw the eastern portion of the property from the city. Approval of this measure is contingent upon Lincoln County approval of corresponding changes to the urban growth boundary.

- Yes
- No

Map for Measure 21-105

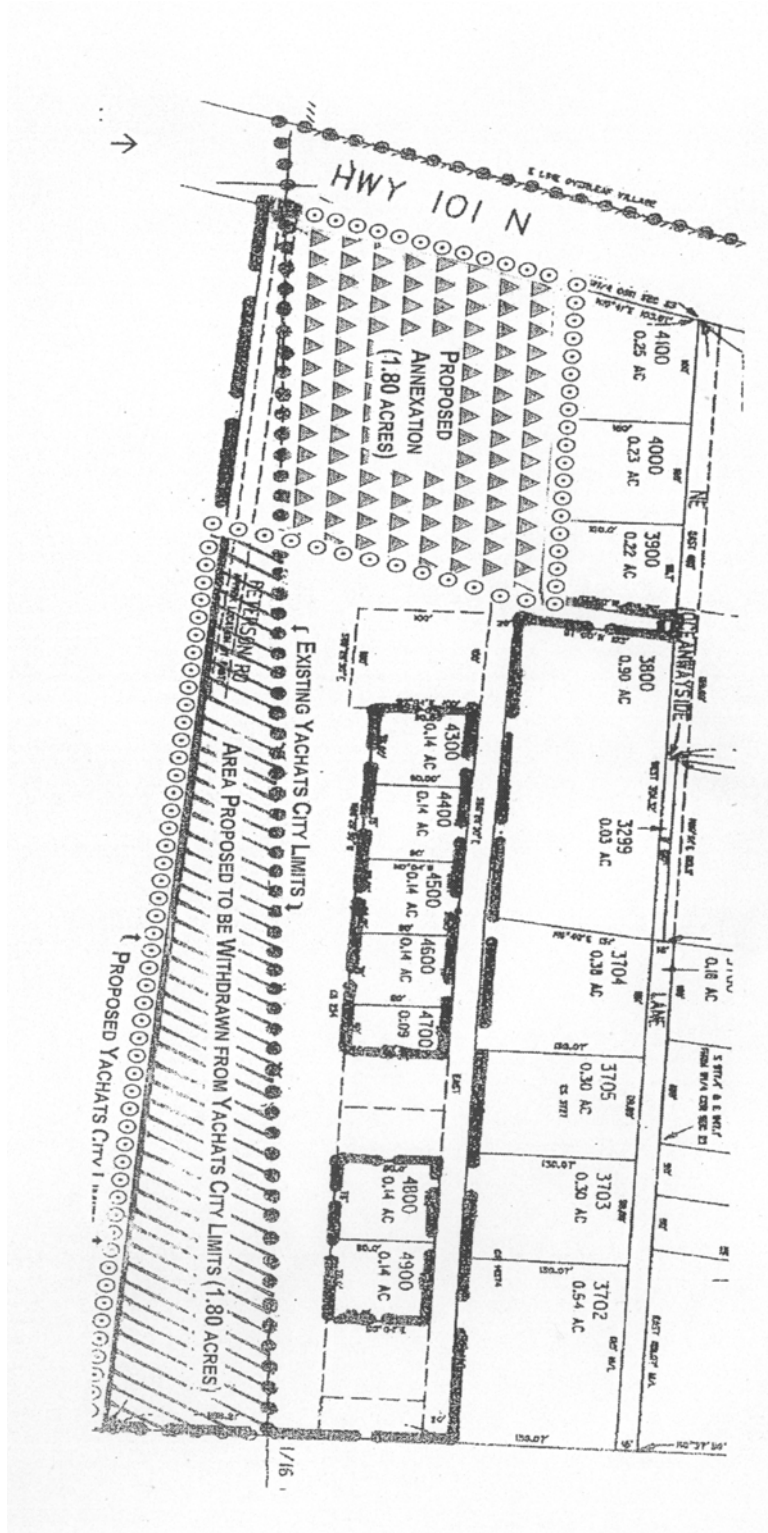

WARNING

Any person who, by use of force or other means, unduly influences an elector to vote in any particular manner or to refrain from voting, is subject, upon conviction, to imprisonment or to a fine, or both. (ORS 254.470)

A Ballot Style: 01 C Seq:0001